

JAMES EDWARD

Comprehensively Cared For



Melbourne Avenue

, London, N13 4SX

£2,500 Per Month



Melbourne Avenue



Description

A tastefully presented three bedroom family home conveniently located close to transport, shops, parks and schools.

- Brilliant Transport Links
- Close to Bowes Park station
- Close to Outstanding Schools
- Available Immediately
- Close to Ample Shops
- Close to Myddleton Road
- Newly Re-Decorated Throughout





Floor Plan

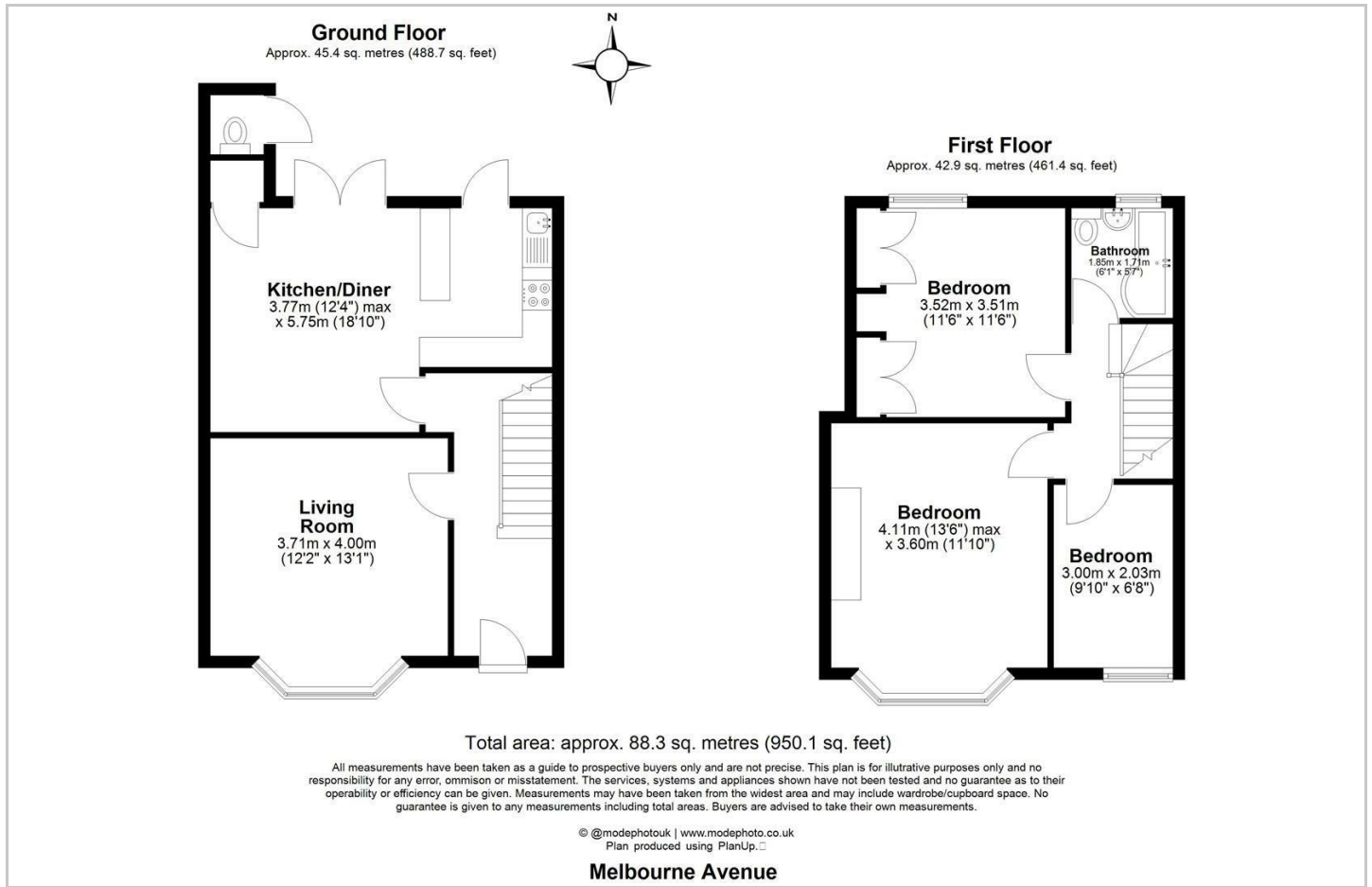

Area Map

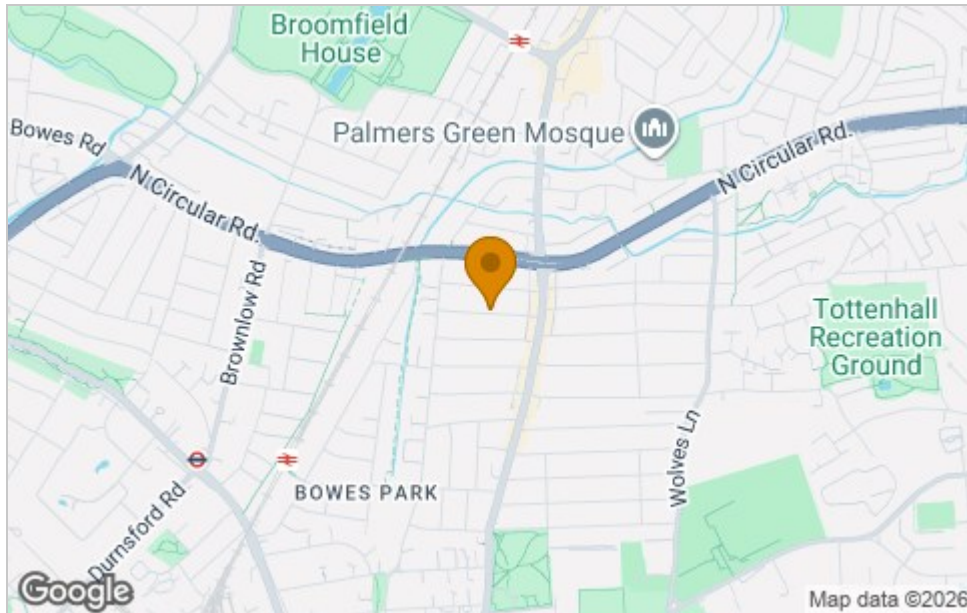

Energy Efficiency Graph

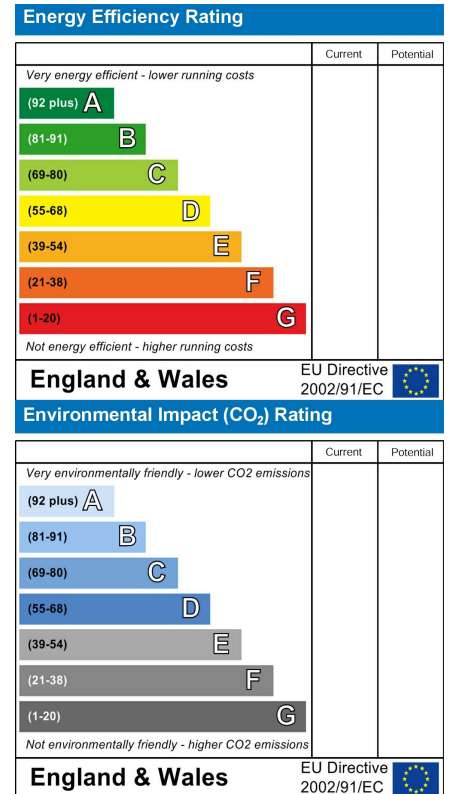

Viewing

Please contact our James Edward Office on 020 7952 5197 if you wish to arrange a viewing appointment for this property or require further information.

These particulars, whilst believed to be accurate are set out as a general outline only for guidance and do not constitute any part of an offer or contract. Intending purchasers should not rely on them as statements of representation of fact, but must satisfy themselves by inspection or otherwise as to their accuracy. No person in this firm's employment has the authority to make or give any representation or warranty in respect of the property.

100 Highbury Park, London, N5 2XE

Tel: 020 7952 5197 Email: info@jamesedwardproperties.co.uk <https://www.jamesedwardproperties.co.uk>